

R 5 STREET

Displacement: 347cc
 Bore and Stroke: 64 x 54mm
 Number of Cylinders: 2
 Use: Street
 Cylinder Head Volume: 21.2cc
 P/N 278-11111-00-00
 Carburetor Size: VM 28 SC
 Right Carburetor P/N 278-14102-00-00
 Left Carburetor P/N 278-14101-00-00
 Ignition Timing: 2.0mm BTDC
 Spark Plug Heat Range: NGK B 8 HS

Special Parts:

Wide Ratio Transmission

R 5 STREET

Port Diagram
Right Cylinder
P/N 278-11321-00-00
Left Cylinder
P/N 278-11311-00-00
All Dimensions in Millimeters:
Tolerance: $\pm 0.5\text{mm}$

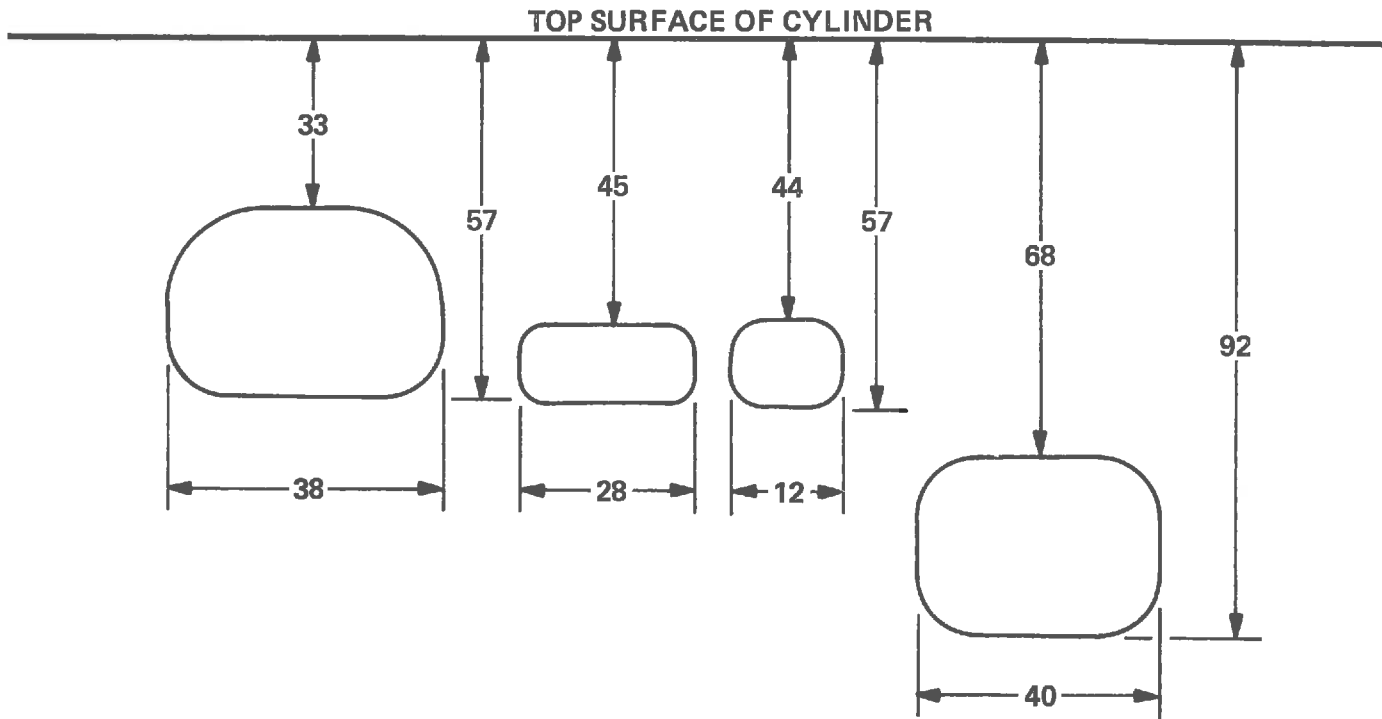

R 5 STREET

Piston Diagram
Piston P/N 278-11631-00-96
All Dimensions in Millimeters:
Tolerance: $\pm 0\text{mm}$

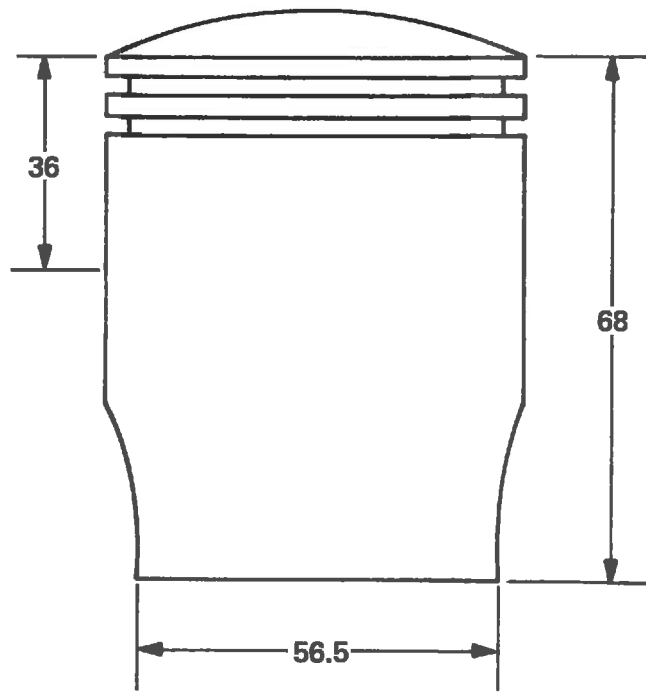

TR 3 ROAD RACER

Model: TR 3 (R 5 Engine used)
 Displacement: 347cc
 Bore and Stroke: 64 x 54mm
 Number of Cylinders: 2
 Use: Road Racer or Drag Racer
 Cylinder Head Volume: 17.7cc
 P/N 328-11111-00-00
 Carburetor Size: VM 34 SC
 P/N 328-14101-00-00
 Ignition Timing: 2.0mm BTDC
 Spark Plug Heat Range: NGK B 10 EN

Special Parts:

Rods: TR 3, Slotted
 P/N 328-11650-09-00
 Bearings: TR 3, Rod Bearings
 Big End – Silver Cage
 P/N 93310-42255-00
 Small End
 P/N 93310-21636-00
 Crankshaft Main Bearings –
 Special Type
 Ignition System:
 CDI Magneto Assembly
 P/N 328-8500-10-00
 Ignition Coil – two each
 P/N 328-82310-60-00
 CDI Unit Assembly
 P/N 328-85540-10-00
 Clutch: TR 3
 Exposed, Dry Type
 P/N 328-16301-10-00
 Primary Gear
 P/N 328-16111-00-00
 Clutch Primary Gear
 P/N 328-16150-10-00 (Use this gear when using exposed, dry type clutch.)
 Covered, Wet Type
 P/N 328-16301-00-00
 Primary Gear
 P/N 328-16111-10-00 (Use this gear when using covered, wet type clutch.)
 TR 3 Close Ratio Transmission 5 or 6 Speed Transmission available
 Transmission Shaft: Special Type for Racing Clutch
 Expansion Chambers: TR 3
 Left Side – P/N 328-14610-00-00
 Right Side – P/N 328-14620-00-00

1972

TR 3 ROAD RACER

Optional Equipment:

Chassis: TR 3

Frame:

P/N 328-21110-00-33

Swing Arm:

P/N 239-22110-00-33

Wheels: TR 3,

18-inch Alloy Rims

Brakes: TR 3 Drum Type

Four Leading Shoes – Front

One Leading, One Trailing – Rear

Gas Tank Assembly: TR 3

P/N 328-24110-00-00

Front Fork Assembly

P/N 328-23100-00-00

Fairing Assembly

P/N 328-28350-00-01

NOTE

When using TR 3 parts in R 5 engine, be sure to check parts book for interchangeability. Many individual parts are not interchangeable, and must be ordered and used as sets.

TR 3 ROAD RACER

Port Diagram
TR 3 Cylinder Used
Left Cylinder
Part No. 328-11311-00-00
Right Cylinder
Part No. 328-11321-00-00
All Dimensions in Millimeters:
Tolerance: $\pm 0.5\text{mm}$

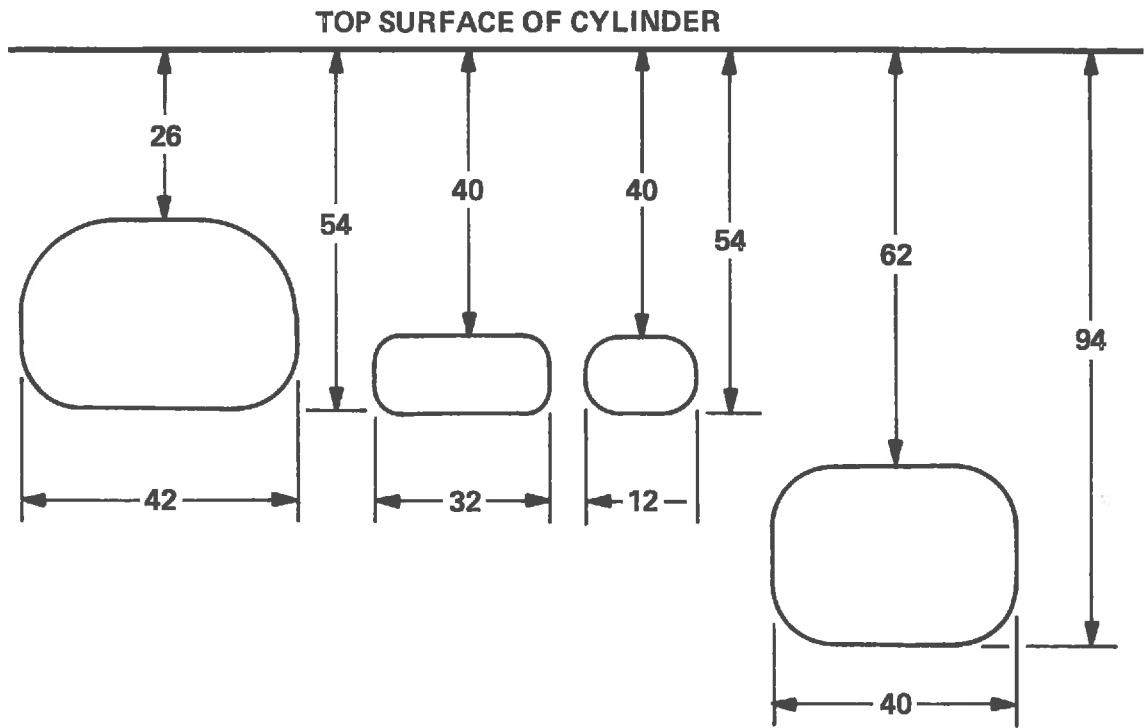

1972

TR 3 ROAD RACER

Piston Diagram

Piston TR 3

Part No. 328-11631-00-96

All Dimension in Millimeters:

Tolerance: $\pm 0\text{mm}$

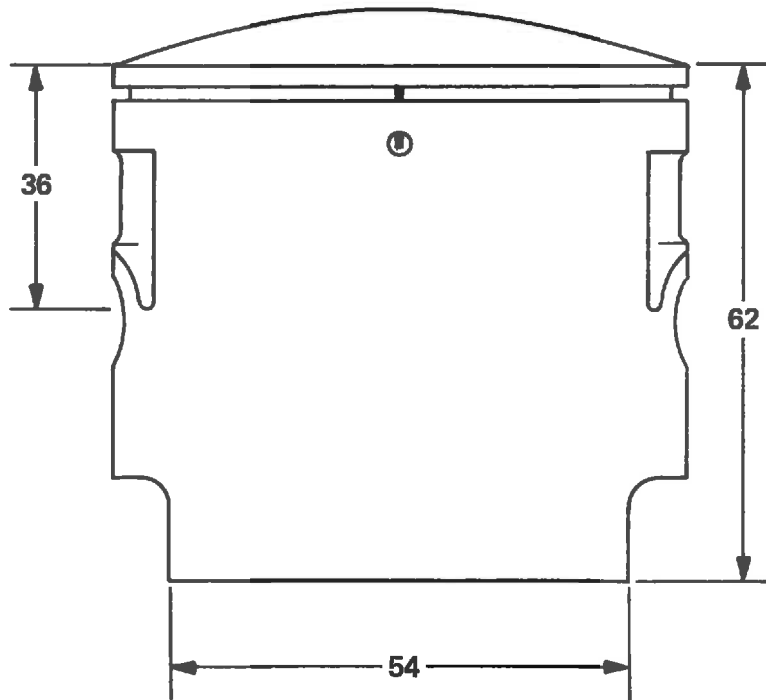

TR 3 ROAD RACER

Expansion Chambers:

Left Expansion Chamber

P/N 328-14610-00-00

Right Expansion Chamber

P/N 328-14620-00-00

Material Thickness 1mm

All Dimensions in Millimeters:

Tolerance: $\pm 1.0\text{mm}$

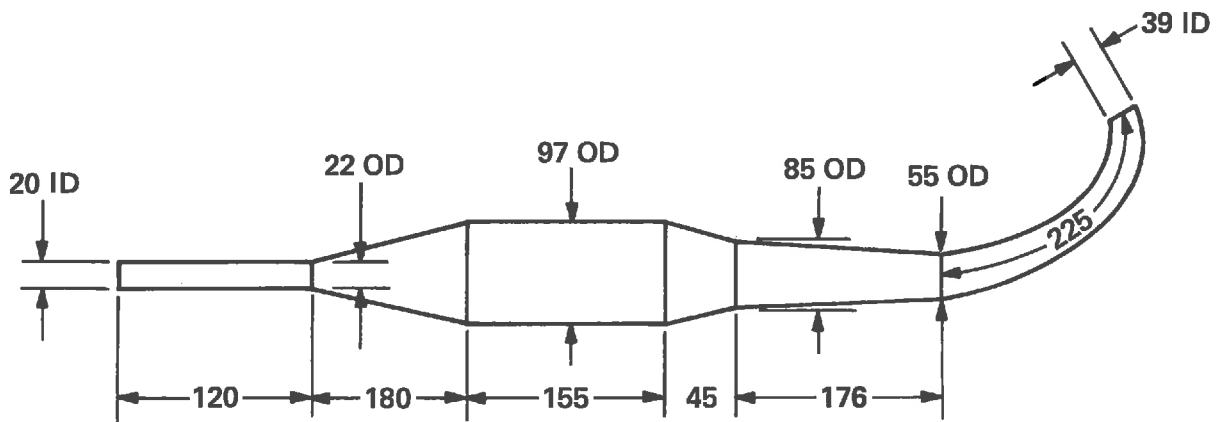

TR 3 SPECIAL

Model: TR 3 (R 5 Engine Used)
 Displacement: 347cc
 Bore and Stroke: 64 x 54mm
 Number of Cylinders: 2
 Use: For prolonged high speed riding, road racing, or drag racing
 Cylinder Head Volume: 18.7cc
 P/N 328-11111-00-00 Modified
 Carburetor Size: VM 34 SC
 P/N 329-14101-00-00
 Ignition Timing: 2.0mm BTDC
 Spark Plug Heat Range: NGK B 10 EP

Special Parts:

Tachometer Idler Gear Set:
 Bearing P/N 933-10215-64-00
 Gear P/N 328-15650-00-00
 Washers – two each – P/N 328-15653-00-00
 Must be installed as a set.

1972

TR 3 SPECIAL

Optional Equipment:

TR 3 SPECIAL

Port Diagram

Left Cylinder

P/N 328-11311-00-00

Right Cylinder

P/N 328-11321-00-00

All Dimensions in Millimeters:

Tolerance: $\pm 0.5\text{mm}$

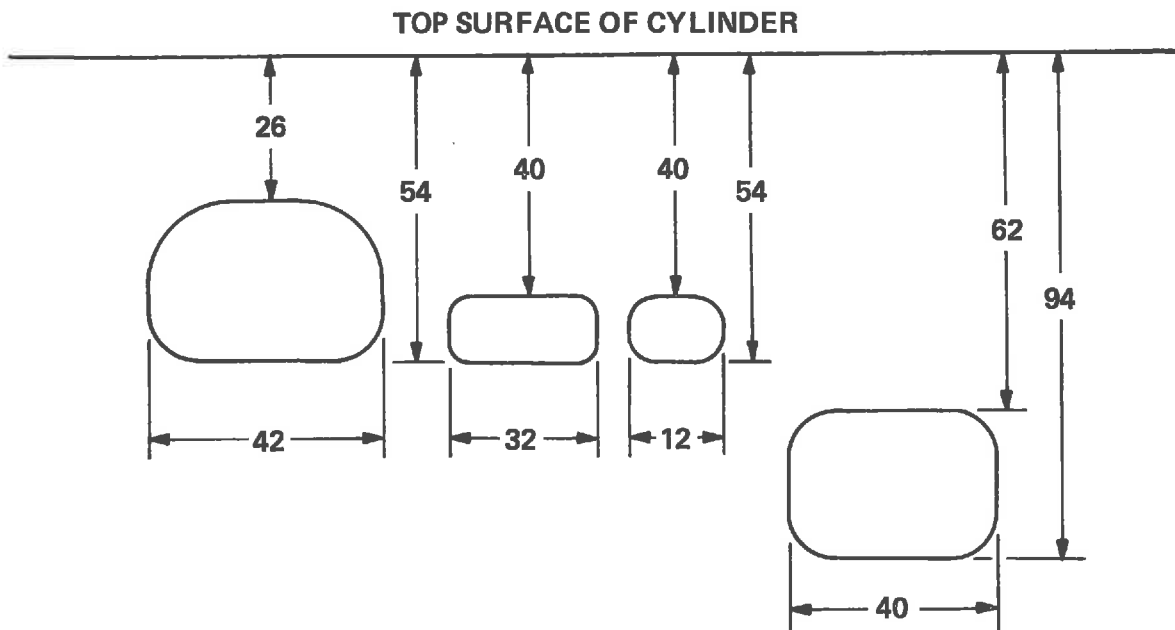

TR 3 SPECIAL

Piston Diagram

Piston TR 3

P/N 328-11631-00-96

All Dimensions in Millimeters:

Tolerance: $\pm 0\text{mm}$ **CAUTION**

After cutting off a portion of the piston skirt, be sure to check for cracks along edge of skirt and around intake ports after each race.

If there is evidence of cracks or extreme wear, replace piston.

NOTE

When modifying piston skirt, be sure to modify the intake side only. This will change port timing.

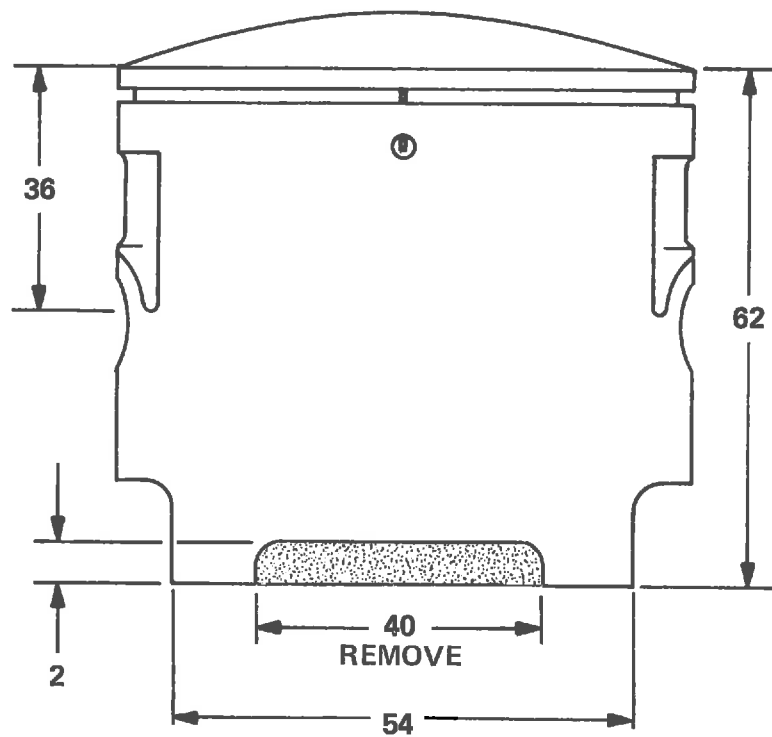

TR 3 SPECIAL

Expansion Chambers:

Left Expansion Chamber –

P/N 328-14610-00-00

Right Expansion Chamber –

P/N 328-14620-00-00

Material Thickness 1mm

All Dimensions in Millimeters:

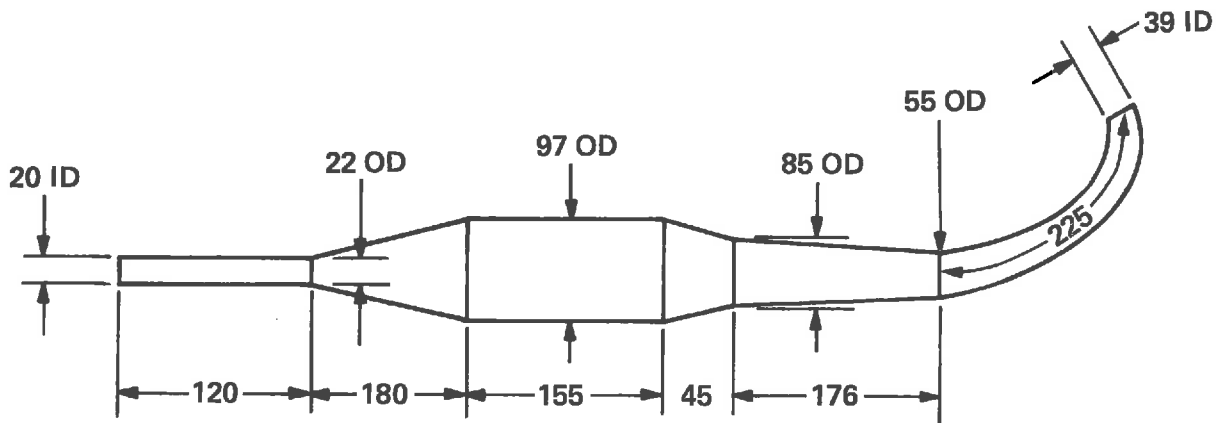
Tolerance: $\pm 1.0\text{mm}$ 

1972

TR 3 SPECIAL

Cylinder Head Diagram

Cylinder Head

Part No. 328-11111-00-00

NOTE

For prolonged high speed racing, reduce compression ratio by increasing cylinder head volume to 18.7cc. Remove material in shaded area [1] to enlarge cylinder head volume.

